

# Model No.DC10WA CHARGER

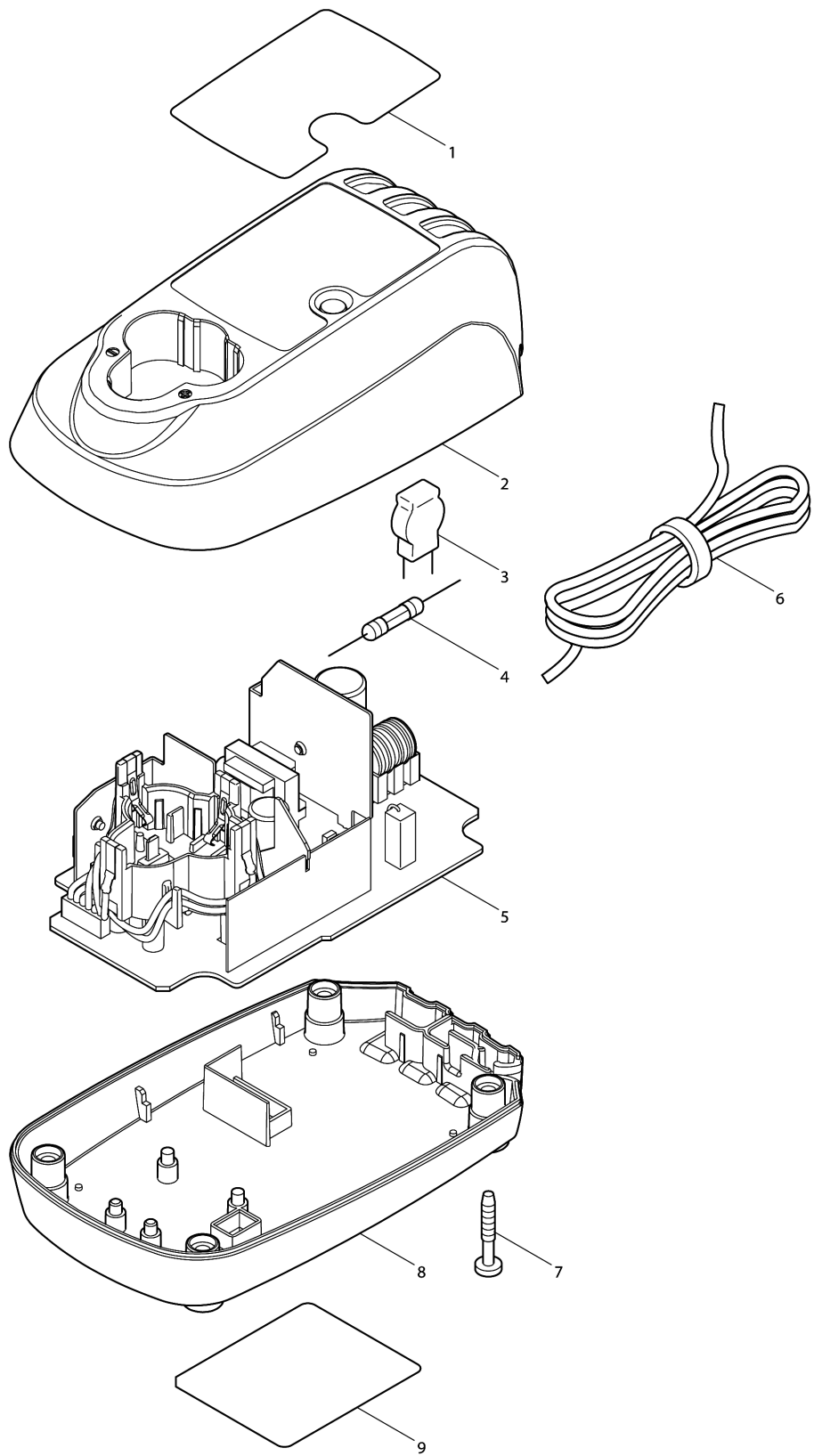



## Model No.DC10WA CHARGER

Item	Parts No.	Description	I/C	Qty	New/Old	Opt. 1	Opt. 2	Note
001A	806973-3	CHARGING CONDITION LABEL		1	*			
001B	806973-3	CHARGING CONDITION LABEL		1	*			
001C	808024-8	CHARGING CONDITION LABEL		1	*			
001D	808024-8	CHARGING CONDITION LABEL		1	*			
001-1A	806973-3	CHARGING CONDITION LABEL	<	1				
001-1B	806973-3	CHARGING CONDITION LABEL	<	1				
001-1C	806973-3	CHARGING CONDITION LABEL	<	1				
001-1D	806973-3	CHARGING CONDITION LABEL	<	1				
002A	158599-0	CHARGER CASE COMPLETE		1				
002B	158599-0	CHARGER CASE COMPLETE		1				
002C	158814-2	CHARGER CASE COMPLETE		1				
002D	158814-2	CHARGER CASE COMPLETE		1				
003	647306-1	VARISTOR		1				
004	652779-5	FUSE		1				
005A	631806-1	CHARGING CIRCUIT COMPLETE		1				
005B	631806-1	CHARGING CIRCUIT COMPLETE		1				
005C	631836-2	CHARGING CIRCUIT COMPLETE		1				
005D	631836-2	CHARGING CIRCUIT COMPLETE		1				
D10		INC. 3,4						
006	667985-9	VINYL CORD 0.75-2-2.0		1				
007	266355-5	TAPPING SCREW BT 4X25		4				
008	450470-7	CHARGER CASE COVER		1				
009	864956-9	DC10WA NAME PLATE		1				

Please order the parts with part number.

Print Date 3/6/2019

